

MODEL NUMBER	PT291261/CT291261	
RATED INPUT	0-120V	0-450 V
RATED OUTPUT	7.07V	7.07V
OPTIMAL LOAD	-----	-----
ACCURACY GRADE	<u>0.1 / 0.2</u>	0.1 / 0.2
DIMENSIONS	 <p>The technical drawings show the component's dimensions in millimeters. The side view (left) indicates a total height of 28.8 mm, a mounting tab height of 4.0 mm, and a central pin diameter of 0.8 mm. The top view (right) shows a square footprint with an outer width of 30.2 mm and an inner width of 15.0 mm. The distance from the top edge to the center of the mounting holes is 20.0 mm, and the distance between the two mounting holes is 7.5 mm on each side of the center.</p>	

MODEL NUMBER	PT290661/CT290661	
RATED INPUT	0-20A	0-250 V
RATED OUTPUT	3.53V	3.53V
OPTIMAL LOAD	>100K	>100K
ACCURACY GRADE	0.1 / 0.2	0.1 / 0.2
DIMENSIONS	<div style="text-align: right; margin-bottom: 10px;"> anchor X: 57.05 mm Y: 227.12 mm </div>	

MODEL NUMBER	PT290791/CT290791	
RATED INPUT	0-100A	0-150 V
RATED OUTPUT	3.53V	3.53V
OPTIMAL LOAD	-----	-----
ACCURACY GRADE	0.1 / 0.2	0.1 / 0.2

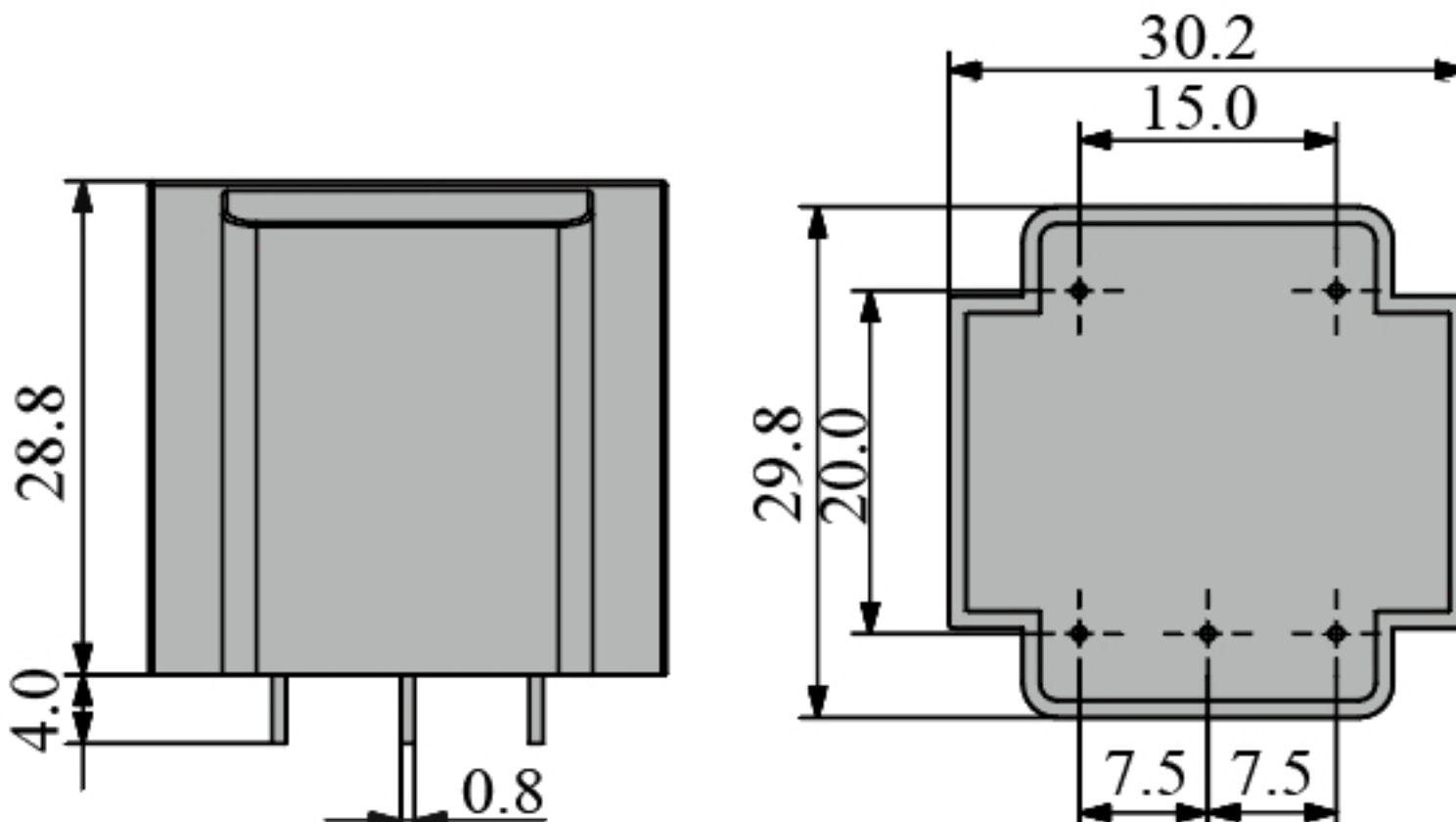
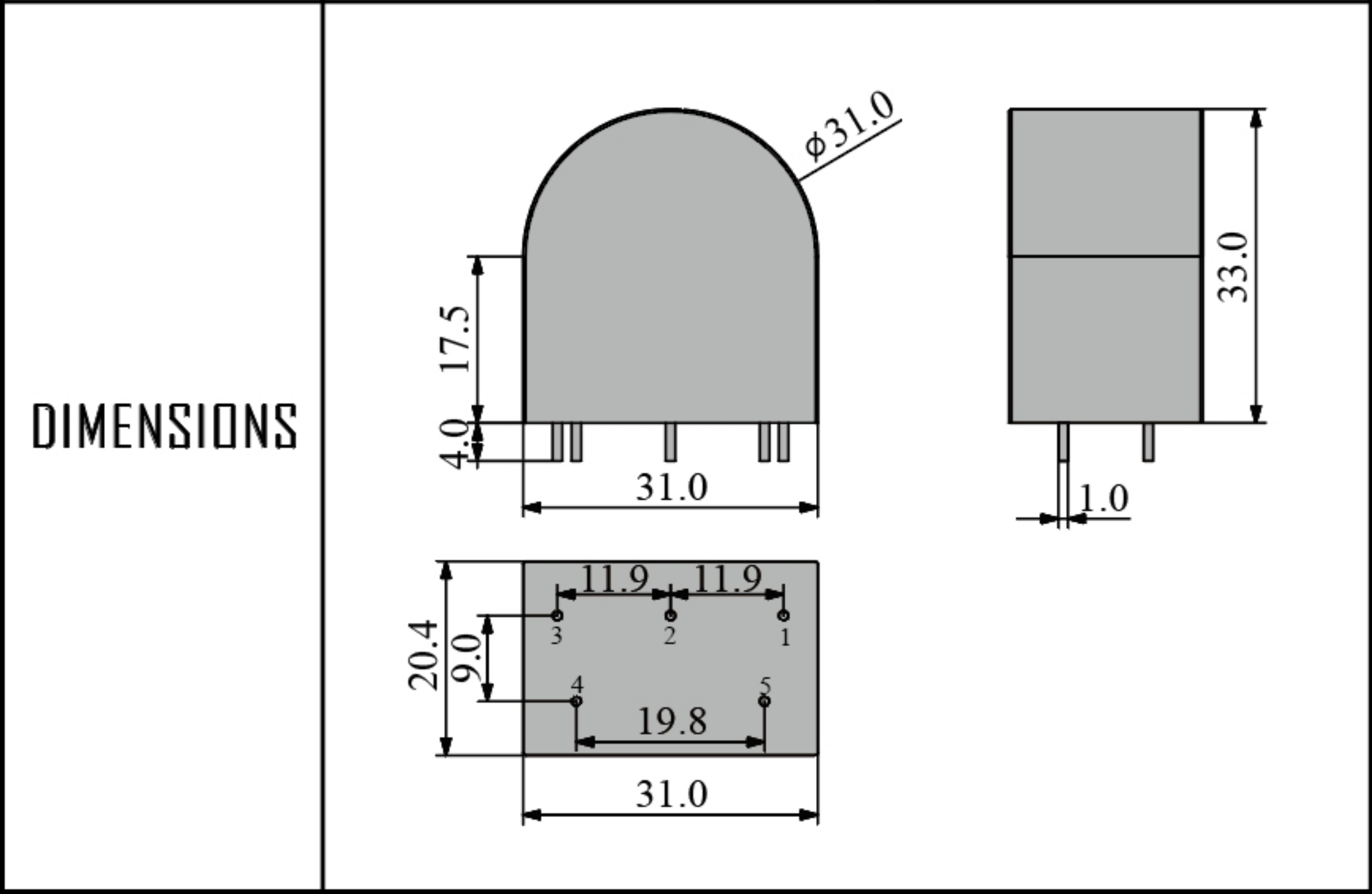

MODEL NUMBER	PT290861/CT290861	
RATED INPUT	0-100A	0-220 V
RATED OUTPUT	3.53V	3.53V
OPTIMAL LOAD	-----	-----
ACCURACY GRADE	0.1 / 0.2	0.1 / 0.2
DIMENSIONS	<p>The technical drawing consists of two views of the transformer. The left view is a side profile showing a rectangular body with a width of 32.0 and a height of 26.0. Below the body are three mounting pins, with the first pin on the left being 4.5 units high. The right view is a top-down circular view of the transformer. The overall diameter is 20.0. The center has a diameter of $\phi 0.8$. Six terminals are arranged around the center, numbered 1 through 6. Terminals 1, 2, and 3 are on the top edge, and terminals 4, 5, and 6 are on the bottom edge. The distance between terminals 1 and 2 is 7.5, and between 2 and 3 is 7.5. The distance between terminals 4 and 5 is 15.0.</p>	

MODEL NUMBER	PT290961 / CT290961	
RATED INPUT	0-100A	0-450 V
RATED OUTPUT	3.53V	3.53V
OPTIMAL LOAD	-----	-----
ACCURACY GRADE	0.1 / 0.2	0.1 / 0.2

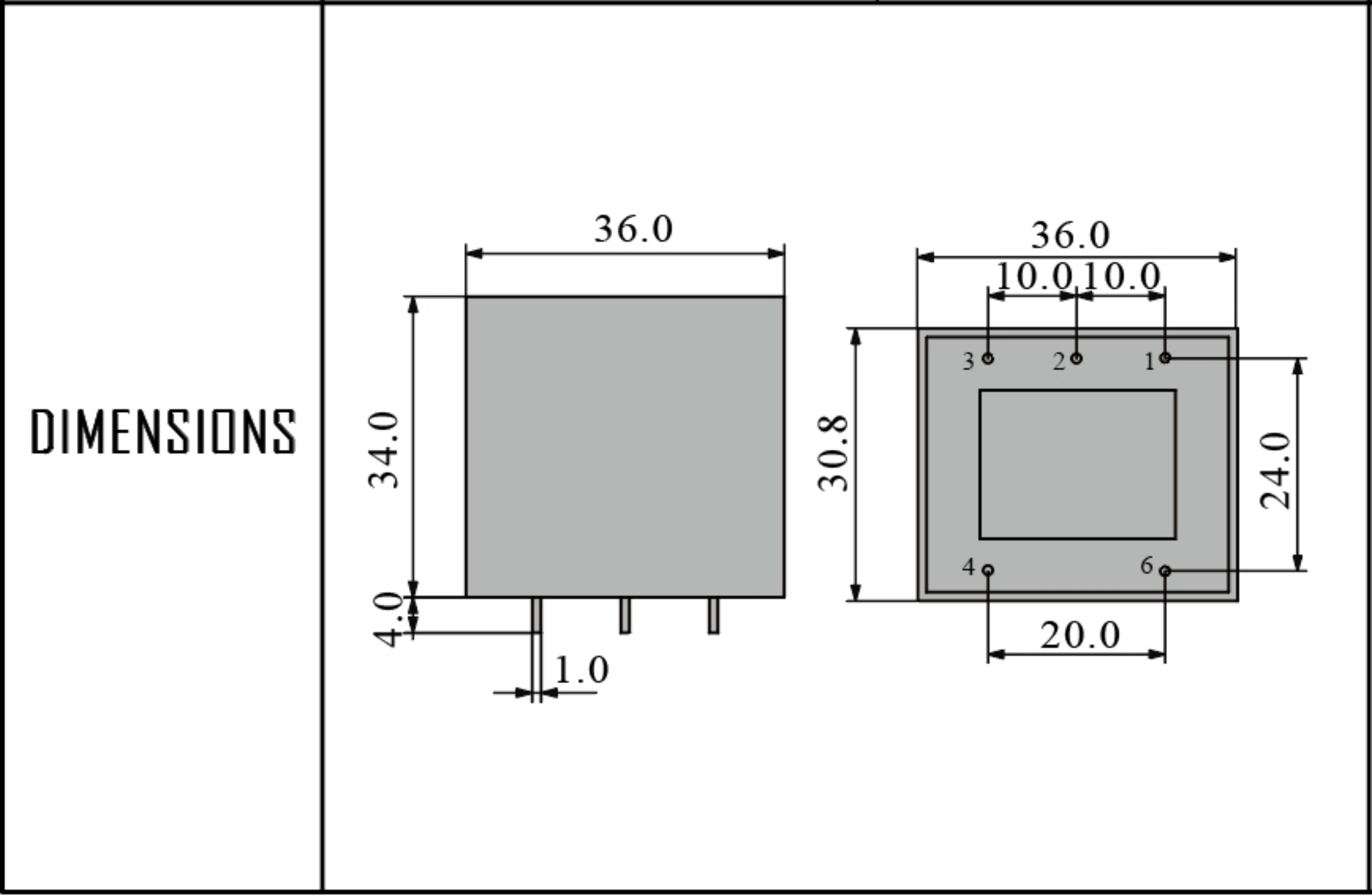

MODEL NUMBER	PT291001/CT291001	
RATED INPUT	0-220V	0-450 V
RATED OUTPUT	7.07V	7.07V
OPTIMAL LOAD	----	----
ACCURACY GRADE	0.1 / 0.2	0.1 / 0.2
DIMENSIONS	<p>Technical drawing showing two views of a rectangular component with dimensions:</p> <ul style="list-style-type: none"> Left view: Height = 31.5, Base width = 5.0, Mounting hole diameter = 1.0. Right view: Length = 31.2, Width = 24.5, Mounting hole diameter = 7.5, Center-to-center spacing = 15.0. 	